



# QMAKS MASOOD

GHMC APPROVED PROJECT  
BANK LOAN APPROVED



PROJECT BY  
QMAKS BUILDERS & DEVELOPERS



# EACH FLAT 1900 SQFT

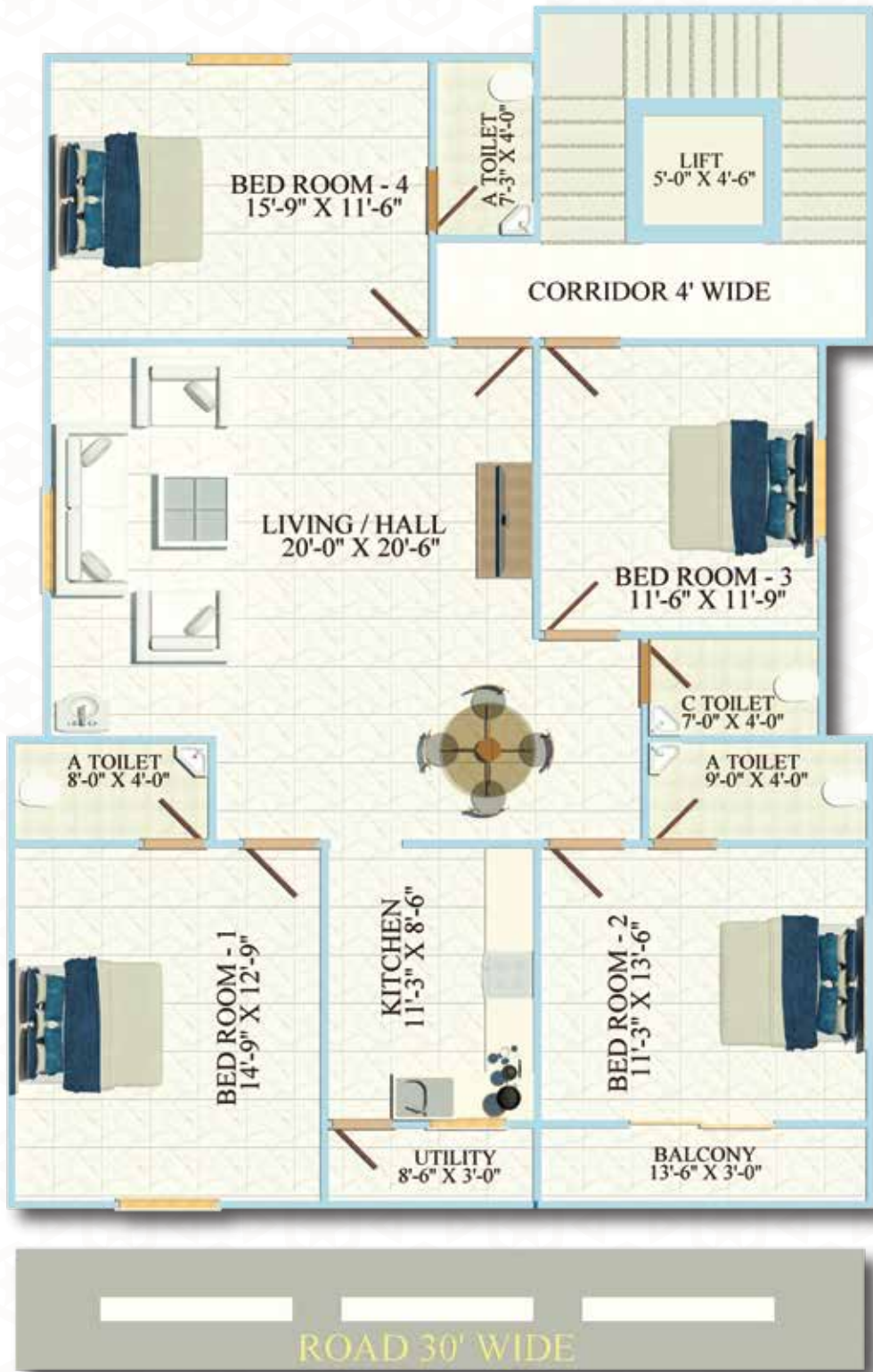

## SPECIFICATIONS

- Structure:** RCC Frames Structures will be as per the provided design in using TMT-550 Steel
- Walls :** Best Quality Fly ash Bricks
- Ceiling :** Gypsum Ceiling in Hall and bedrooms
- Plastering:** External & Internal Plastering with C.M in two Coats with sponge finishing
- Flooring:** First Class Vitrified Tiles 24" X 24" with Skirting
- Bathrooms:** Each Toilet Ceramic Tiles Flooring Designer Ceramic Tiles Dado up to Door Height European / Indian type water closet. Provision for Geyser will be given





# FLOOR PLAN PARKING

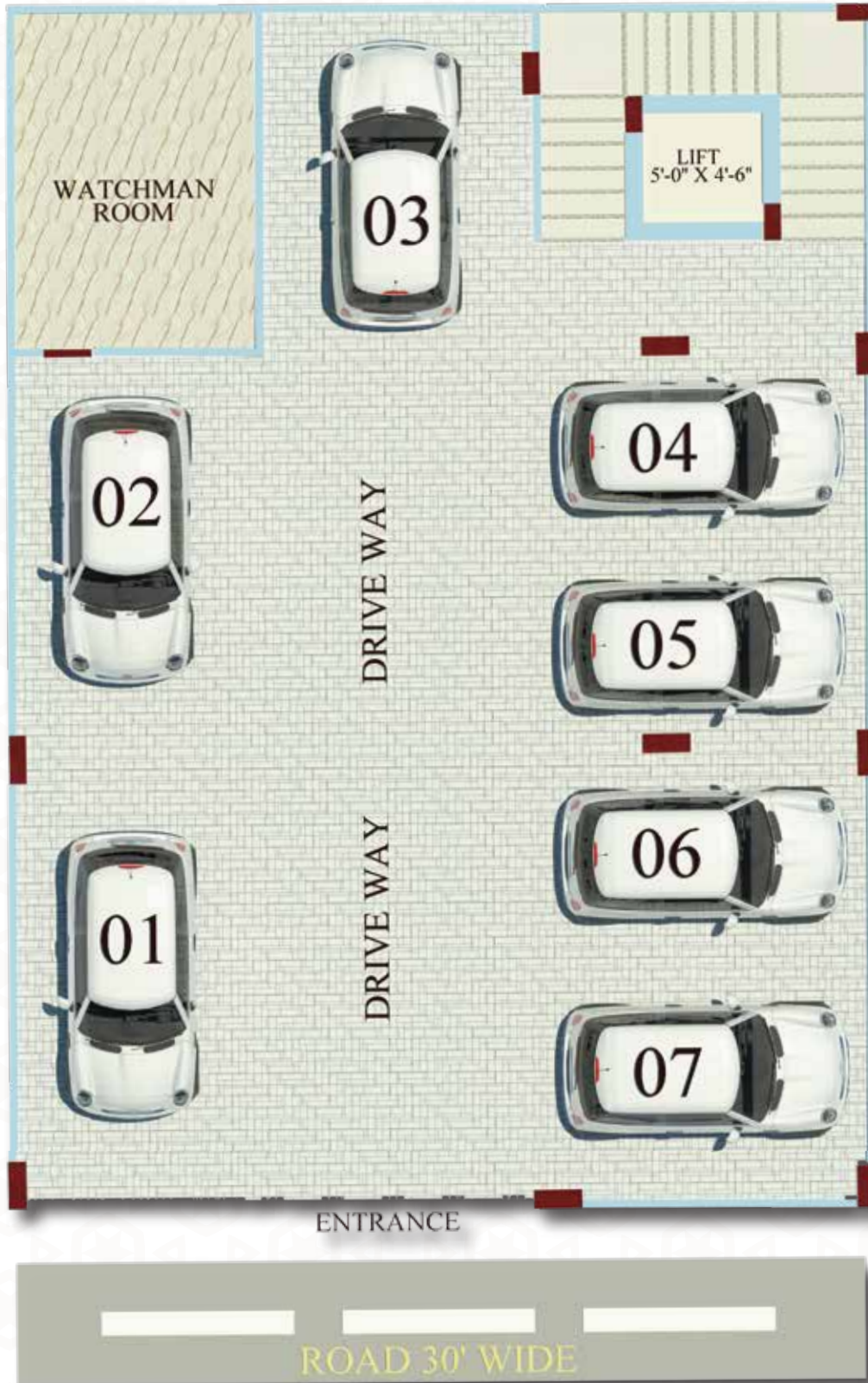

- Doors :** Main Door Teakwood Frame and Teakwood Shutter with Polish Internal Doors  
Frames Teakwood with Molding Doors
- Windows:** 3 Track Aluminum Frames with Iron Safety Grills
- Kitchen:** Granite Plate form with Stainless Steel Sink
- Painting:** Two Coats Birla putty with Acrylic Plastic Emulsion
- Lift :** 6 Passenger Standard Lift
- Backup:** Backup for Lift & Common Lights

## NOTE

Car parking and amenities  
with extra cost

Persons desiring to alter /modify their flat shall inform the same  
at the time of booking & sign the request for modification form

Registration, GST applicable  
As per Govt. Norms.

# AN ENIGMATIC FUSION OF OLD WORLD CHARM & URBAN DEVELOPMENT

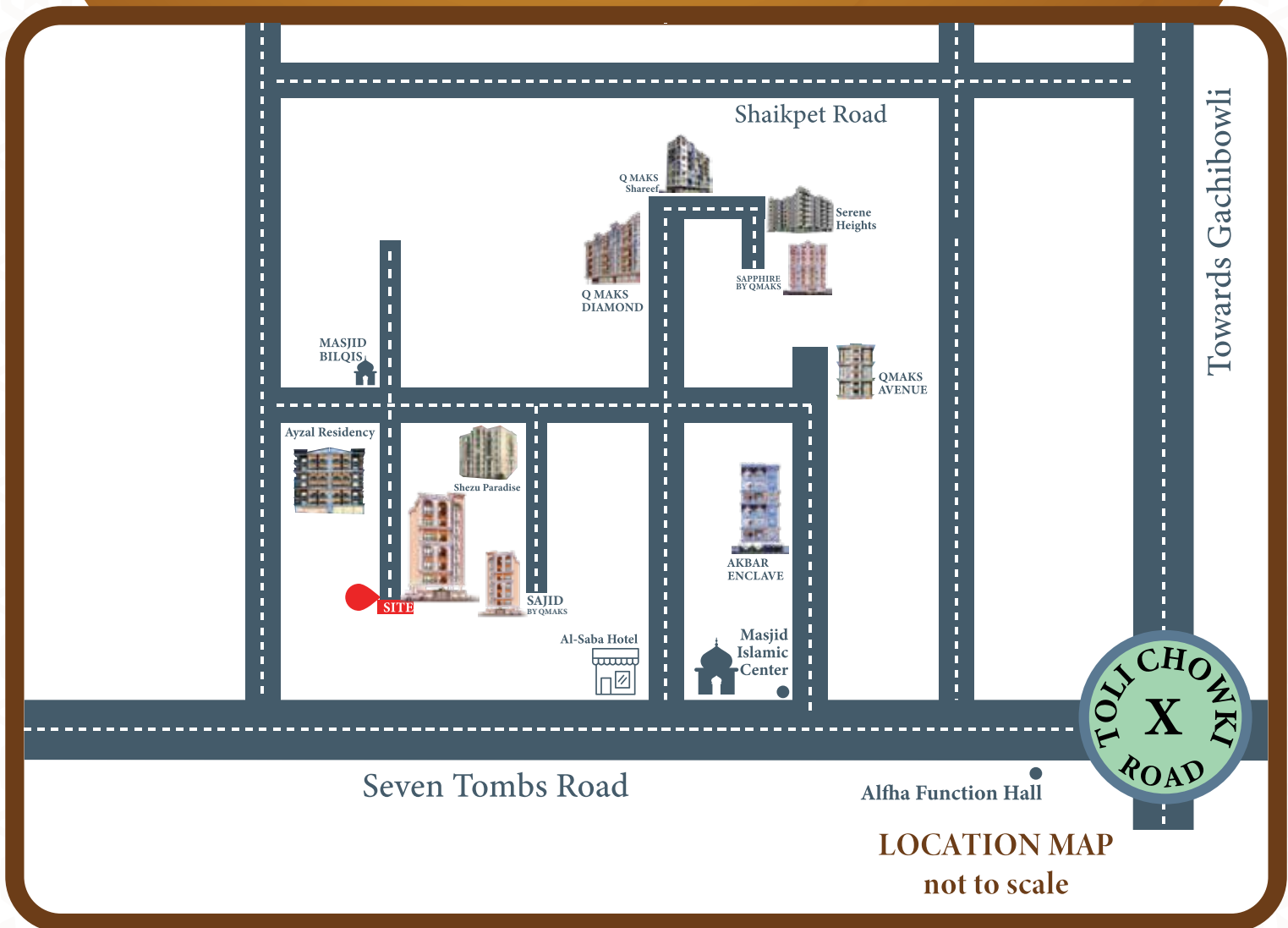

**QMAKS**  
**BUILDERS & DEVELOPERS**

Plot No. 87, 88, SA Colony, Tolichowki, Hyd.  
Website: [www.qmaks.com](http://www.qmaks.com) | E-mail: [sales@qmaks.com](mailto:sales@qmaks.com)  
**TOLL FREE NO. : 1800 1200 786**



NOTE: This brochure is only a conceptual presentation of the project and not a legal offering the promoters reserves right to make changes in plans, specifications and elevation as deemed fit.

